









# SEDI VITI E SVASATORI

## COUNTERBORE CUTTERS AND COUNTERSINKS

			Pagina Page
<b>FSB</b> Frese per Sedi Viti Counterbore Cutters	Codice Code	Ø (D mm)	294
	401	M3 ÷ M12	294
	402	M10 ÷ M20	294
	403	M3 ÷ M10	294
<b>PSV</b> Svasatori Countersinks	Codice Code	Ø (D mm)	295
	361	6,3 ÷ 25,0	295
	362	4,3 ÷ 31,0	295
	367	12,4 ÷ 31,0	296
	363	8,0 ÷ 25,0	296

# FRESE PER SEDI VITI COUNTERBORE CUTTERS

## 401

Sedi viti  
Counterborers

HSSE

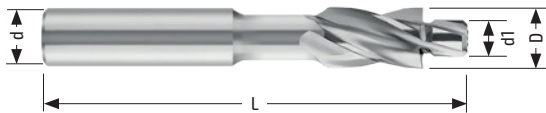
ISO  
4205DIN  
373

dv	d1 e8	D z9	L	d h8	Z	Non rivestito Uncoated
M3	3,2	6,0	71	6	4	FSB401003
M4	4,3	7,4	71	8	4	FSB401004
M5	5,3	9,4	80	10	4	FSB401005
M6	6,4	10,4	80	10	4	FSB401006
M8	8,4	13,5	100	12	4	FSB401008
M10	10,5	16,5	100	12	4	FSB401010
M12	13,0	20,0	100	12	4	FSB401012

## 402

Sedi viti  
Counterborers

HSSE

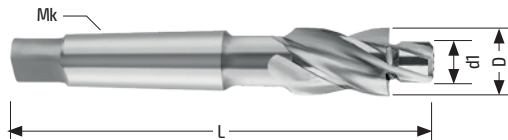
ISO  
4205DIN  
373

dv	d1 e8	D z9	L	Mk	Z	Non rivestito Uncoated
M10	10,5	16,5	145	2	4	FSB402010
M12	13,0	20,0	150	2	4	FSB402012
M14	15,0	23,0	160	2	4	FSB402014
M16	17,0	25,0	165	2	4	FSB402016
M18	19,0	28,0	175	2	4	FSB402018
M20	21,0	31,0	200	3	4	FSB402020

## 403

Sedi viti  
Counterborers

HSSE

ISO  
4206DIN  
1866

dv	d1 e8	D z9	L	d h8	Z	Non rivestito Uncoated
M3	3,2	6,5	71	6	4	FSB403003
M4	4,3	8,6	71	8	4	FSB403004
M5	5,3	10,6	80	10	4	FSB403005
M6	6,4	12,6	80	10	4	FSB403006
M8	8,4	16,7	100	12	4	FSB403008
M10	10,5	20,7	100	12	4	FSB403010

# SVASATORI COUNTERSINKS

## 361

Svasatore  
Countersink

HSSE

Z3

DIN  
334C



D z9	d1	d h9	L	Non rivestito Uncoated	Balinit® Alcrona
6,3	1,5	5	47	PSV361063	NIG361063
8,3	2,0	6	52	PSV361083	NIG361083
10,4	2,5	6	53	PSV361104	NIG361104
12,4	3,0	8	60	PSV361124	NIG361124
16,5	4,0	10	65	PSV361165	NIG361165
20,5	4,0	10	69	PSV361205	NIG361205
25,0	5,0	10	75	PSV361250	NIG361250

## 362

Svasatore  
Countersink

HSSE

Z3

DIN  
335C



D z9	d1	d h9	L	Non rivestito Uncoated	Balinit® Alcrona
4,3	1,3	4	40	PSV362043	NIG362043
5,3	1,5	4	40	PSV362053	NIG362053
6,3	2,0	5	45	PSV362063	NIG362063
7,3	2,0	6	50	PSV362073	NIG362073
8,3	2,5	6	50	PSV362083	NIG362083
9,4	3,0	6	50	PSV362094	NIG362094
10,4	3,0	6	50	PSV362104	NIG362104
12,4	3,0	8	56	PSV362124	NIG362124
16,5	4,0	10	60	PSV362165	NIG362165
20,5	4,0	10	63	PSV362205	NIG362205
25,0	4,0	10	67	PSV362250	NIG362250
31,0	4,0	12	71	PSV362310	NIG362310

### SIL SERVICE

L'esperienza Silmax dimostra che un utensile correttamente affilato ha un rendimento uguale a quello nuovo.

Silmax experience shows that a properly sharpened tool grants the same performances of a new tool.



Riaffilatura e  
rigenerazione  
Resharpener  
and Reconditioning



Esecuzione  
perfetta  
Perfect  
Execution



Rivestimento  
PVD  
PVD Coating



Trattamento  
4S  
4S Treatment



Consegna  
rapida  
Fast Delivery

**367**Svasatore per l'impiego a mano  
Countersinking with flatted shanks

HSSE

Z3

DIN  
335C

D z9	d1	d h9	L	Non rivestito Uncoated	Balinit® Alcrona
12,4	3,0	8	56	PSV367124	NIG367124
16,5	4,0	10	60	PSV367165	NIG367165
20,5	4,0	10	63	PSV367205	NIG367205
25,0	4,0	10	67	PSV367250	NIG367250
31,0	4,0	12	71	PSV367310	NIG367310

**363**Svasatore  
Countersinking cutter

HSSE

Z3

DIN  
335C

D z9	d1	d h9	L	Non rivestito Uncoated	Balinit® Alcrona
8,0	2,0	6	49	PSV363080	NIG363080
12,5	2,8	8	54	PSV363125	NIG363125
16,0	3,2	10	57	PSV363160	NIG363160
20,0	3,5	10	59	PSV363200	NIG363200
25,0	3,8	10	63	PSV363250	NIG363250

Notes

## ITALY

Silmax SpA  
Via Fucine, 9  
10074 Lanzo Torinese (TO)  
Tel.: +39 0123 940 301  
Fax: +39 0123 940 339  
silmax@silmax.it

## SLOVAKIA

Silmax Slovakia S.R.O  
Cédrová 4377/18  
Dubnica nad Váhom, 018 41  
Tel.: +39 348 688 3691  
odbyt@silmax.com

## CHINA

Silmax Wuxi Trading Co., Ltd  
Room 1612, Building No.1  
1<sup>st</sup> Financial Street,  
Taihu New Town, Wuxi  
Jiangsu, 214000  
Tel.: +86 051081905985  
Fax: +86 051081905987  
sales@silmax.com

## INDIA

Silmax Tools India Pvt Ltd,  
No .514, First Floor, 16th Cross  
Indiranagar 2nd Stage  
Bangalore - 560038, Karnataka  
Tel.: +91 802 525 2555  
sales@silmax.in

## UFFICIO VENDITE SALES

vendite@silmax.it  
+39.0123.940332  
+39.0123.940339

## UFFICIO TECNICO TECHNICAL SUPPORT

assistenza@silmax.it  
+39.0123.940301  
+39.0123.940349

**silmax.it**

